

Cambridge Waste Water Treatment Plant Relocation Project  
Anglian Water Services Limited

# Hedgerow Regulations and Tree Preservation Order Plans

Application Document Reference: 4.8  
PINS Project Reference: WW010003  
APFP Regulation No. 5(2)o

Revision No. 05  
2<sup>nd</sup> April 2024

<b>Document title</b>	Hedgerow Regulations and Tree Preservation Plans
<b>Version No.</b>	C05
<b>Date Approved</b>	28.01.23
<b>Date 1<sup>st</sup> Issued</b>	30.01.23

## Version History

<b>Version</b>	<b>Date</b>	<b>Author</b>	<b>Description of change</b>
C01	30.01.23	-	DCO Submission
C02	13.10.23	-	Key Plan and Sheet 10 updated to reflect changes to the Scheme Order Limits
C03	22.01.24	-	Sheet 8 updated to reflect the retention of Important hedgerow H23-H24
C04	19.02.24	-	Sheets 1 to 10 (excluding sheet 8) updated to reflect an update in the status of hedgerows not affected by the Proposed Development. Sheet 10 H27-28 changed to retained, H23 –H24 updated to change status to not important.
C05	02.04.24	-	Sheets 1 to 10 have been updated with the following: All hedgerows outside the Scheme Order Limits removed from the plans; All hedgerows within the SoL added (regardless of status); H25-H26 (Burgress’s Drove) changed to retained and changed to important; H25-H26 (new) & H27-H28 added; H29-H30 added.



## Contents

<b>1 Introduction .....</b>	<b>1</b>
-----------------------------	----------

## Tables

<b>Table 1-1: Schedule of plans in this application document.....</b>	<b>1</b>
---	----------

# 1 Introduction

- 1.1.1 The Hedgerow Regulations and Tree Preservation Plans (the Plans), listed in Table 1.1, relate to an application made by Anglian Water Services Limited (the “Applicant”) under section 37 of the Planning Act 2008 (the “2008 Act”) for a Development Consent Order (DCO) for the Cambridge Waste Water Treatment Plant Relocation Project.
- 1.1.2 The Plans are included in the DCO application in compliance with Regulations 5(2)(l) and 5(2)(o) of the Infrastructure Planning (Applications: Prescribed Forms and Procedure) Regulations 2009 (the “2009 Regulations”), which require:
  - “5(2) The application must be accompanied by—*
  - (l) where applicable, a plan with accompanying information identifying—*
  - (ii) habitats of protected species, important habitats or other diversity features;*
  - (o) “any other plans, drawings and sections necessary to describe the proposals for which development consent is sought, showing details of design, external appearance, and the preferred layout of buildings or structures, drainage, surface water management, means of vehicular and pedestrian access, any car parking to be provided, and means of landscaping;”*
- 1.1.3 For ease of cross referencing, the drawing sheets been provided with the same sheet layout, including Inset Plans and even where a particular sheet might not be relevant to a set of plans, for the following application documents: General Arrangement Plans (Application Document Reference 4.2), Works Plans (Application Document Reference 4.3), Rights of Way Plans (Application Document Reference 4.6), Access & Traffic Regulation Order Plans (Application Document Reference 4.7), and Hedgerow and Tree Preservation Order Plans (Application Document Reference 4.8).
- 1.1.4 As these Plans are part of the application documentation, they should be read alongside and are informed by the other application documentation. In particular, these Plans should be read alongside Schedule 15 (Removal of Hedgerows) of the Draft Development Consent Order (Application Document Reference 2.1) and the Works Plans (Application Document Reference 4.3).

**Table 1-1: Schedule of plans in this application document**

Application Document Ref	Document Title	Drawing Number	Revision	Status
4.8.0	4.8.0 Hedgerow Regulations and Tree Preservation Plans - Key Plan	00001-100006-CAMEST-ZZZ-LAY-Z-9820	CO2	S4

Application Document Ref	Document Title	Drawing Number	Revision	Status
4.8.1	4.8.1 Hedgerow Regulations and Tree Preservation Plans – Sheet 1	00001-100006-CAMEST-ZZZ-LAY-Z-9021	CO2	S4
4.8.2	4.8.2 Hedgerow Regulations and Tree Preservation Plans – Sheet 2	00001-100006-CAMEST-ZZZ-LAY-Z-9022	CO2	S4
4.8.3	4.8.3 Hedgerow Regulations and Tree Preservation Plans – Sheet 3	00001-100006-CAMEST-ZZZ-LAY-Z-9023	CO3	S4
4.8.4	4.8.4 Hedgerow Regulations and Tree Preservation Plans – Sheet 4	00001-100006-CAMEST-ZZZ-LAY-Z-9024	CO3	S4
4.8.5	4.8.5 Hedgerow Regulations and Tree Preservation Plans – Sheet 5	00001-100006-CAMEST-ZZZ-LAY-Z-9025	CO3	S4
4.8.6	4.8.6 Hedgerow Regulations and Tree Preservation Plans – Sheet 6	00001-100006-CAMEST-ZZZ-LAY-Z-9026	CO3	S4
4.8.7	4.8.7 Hedgerow Regulations and Tree Preservation Plans – Sheet 7	00001-100006-CAMEST-ZZZ-LAY-Z-9027	CO3	S4
4.8.8	4.8.8 Hedgerow Regulations and Tree Preservation Plans – Sheet 8	00001-100006-CAMEST-ZZZ-LAY-Z-9028	CO3	S4
4.8.9	4.8.9 Hedgerow Regulations and Tree Preservation Plans – Sheet 9	00001-100006-CAMEST-ZZZ-LAY-Z-9029	CO3	S4
4.8.10	4.8.10 Hedgerow Regulations and Tree Preservation Plans – Sheet 10	00001-100006-CAMEST-ZZZ-LAY-Z-9030	CO4	S4



GENERAL NOTES

1. THESE PLANS SHOULD BE READ IN CONJUNCTION WITH SCHEDULE 15 (REMOVAL OF HEDGEROWS) TO THE DRAFT DEVELOPMENT CONSENT ORDER (APPLICATION DOCUMENT REFERENCE: 2.1) AND THE WORKS PLANS (APPLICATION DOCUMENT REFERENCE: 4.3)
2. THE LEGEND IS IDENTICAL ON ALL SHEETS OF THE HEDGEROW PLANS AND THEREFORE NOT ALL ITEMS DETAILED IN THE LEGEND ARE REPRESENTED ON EACH SHEET.

LEGEND

- SCHEME ORDER LIMITS
- LAND OUTSIDE ORDER LIMITS
- HEDGEROW RETAINED
- HEDGEROW REMOVED
- IMPORTANT HEDGEROW RETAINED
- IMPORTANT HEDGEROW REMOVED
- CONSERVATION AREA BAITS BITE LOCK
- CONSERVATION AREA FEN DITTON
- INDIVIDUAL TREE REMOVED
- H#** START & END POINT OF HEDGEROW TO BE REMOVED

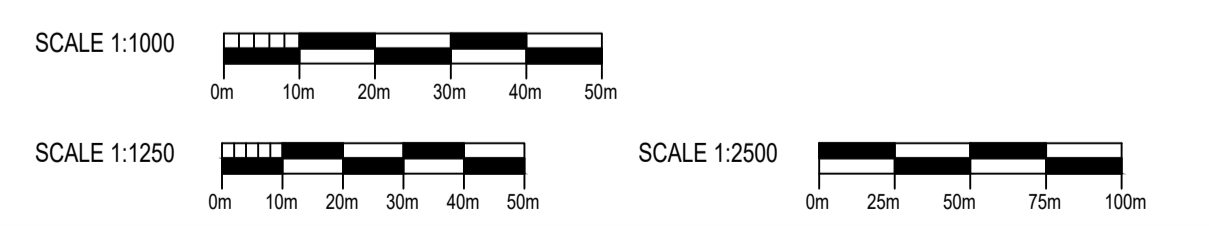
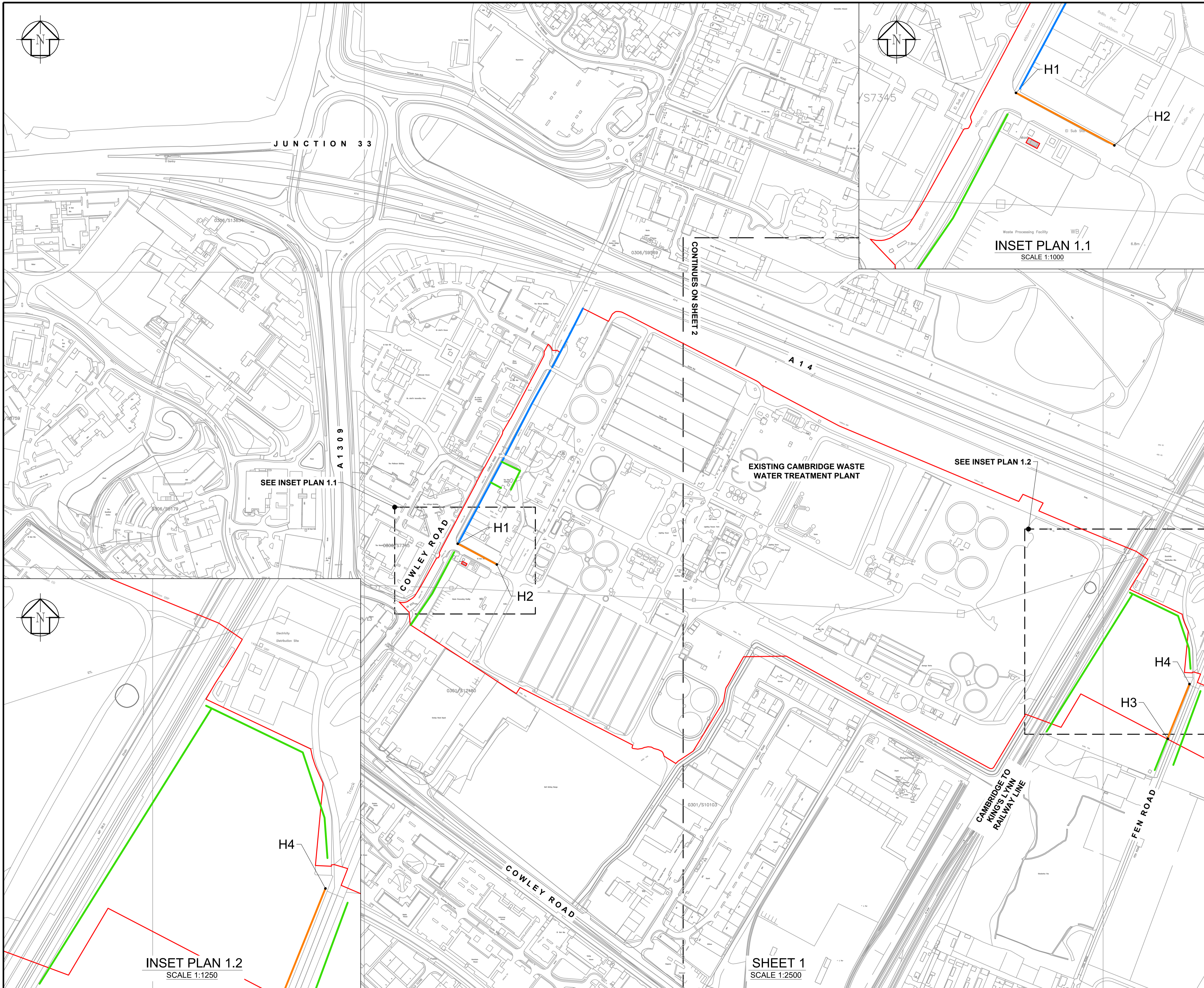

DES'D: -	DATE: 28/03/24	SCALE: AS SHOWN @A1
DRAWN: DP	DATE: 28/03/24	
CHK'D: MR	DATE: 28/03/24	
APP'D: MH	DATE: 28/03/24	
REV	DATE	DETAILS
S4	DP	MR
S4	JL	MR
STAT	BY	CHK
		APP

DES'D: -	DATE: 28/03/24	SCALE: AS SHOWN @A1
DRAWN: DP	DATE: 28/03/24	
CHK'D: MR	DATE: 28/03/24	
APP'D: MH	DATE: 28/03/24	
REV	DATE	DETAILS
S4	DP	MR
S4	JL	MR
STAT	BY	CHK
		APP

PROJECT TITLE  
**CAMBRIDGE WASTE WATER TREATMENT PLANT RELOCATION PROJECT**

DRAWING TITLE  
**4.8.1 HEDGEROW REGULATIONS AND TREE PRESERVATION PLANS SHEET 1 REGULATION 5(2)(I)(ii) & 5(2)(o)**



The plan is produced by Anghian Water Services Limited, from Ordnance Survey Crown Copyright, Licence 100022432. This map is to be used for the purposes of viewing the location of Anghian Water plant only. Any other use of the map data or further copies are not permitted. This notice is not intended to exclude or restrict liability for death or personal injury resulting from negligence. The original document stored in the BIM 360 Doc Project carry the version, suitability code, revision and approval information. Prints are uncontrolled and shall not be used for construction.

DRAWING No. **00001-100006-CAMEST-ZZZ-LAY-Z-9021**

REV. STAT. **A1**  
**C02 S4**



GENERAL NOTES

1. THESE PLANS SHOULD BE READ IN CONJUNCTION WITH SCHEDULE 15 (REMOVAL OF HEDGEROWS) TO THE DRAFT DEVELOPMENT CONSENT ORDER (APPLICATION DOCUMENT REFERENCE: 2.1) AND THE WORKS PLANS (APPLICATION DOCUMENT REFERENCE: 4.3)
2. THE LEGEND IS IDENTICAL ON ALL SHEETS OF THE HEDGEROW PLANS AND THEREFORE NOT ALL ITEMS DETAILED IN THE LEGEND ARE REPRESENTED ON EACH SHEET.

LEGEND

- SCHEME ORDER LIMITS
- LAND OUTSIDE ORDER LIMITS
- HEDGEROW RETAINED
- HEDGEROW REMOVED
- IMPORTANT HEDGEROW RETAINED
- IMPORTANT HEDGEROW REMOVED
- CONSERVATION AREA BAITS BITE LOCK
- CONSERVATION AREA FEN DITTON
- INDIVIDUAL TREE REMOVED
- H#** START & END POINT OF HEDGEROW TO BE REMOVED

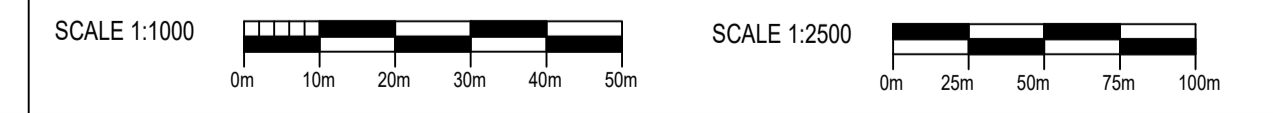
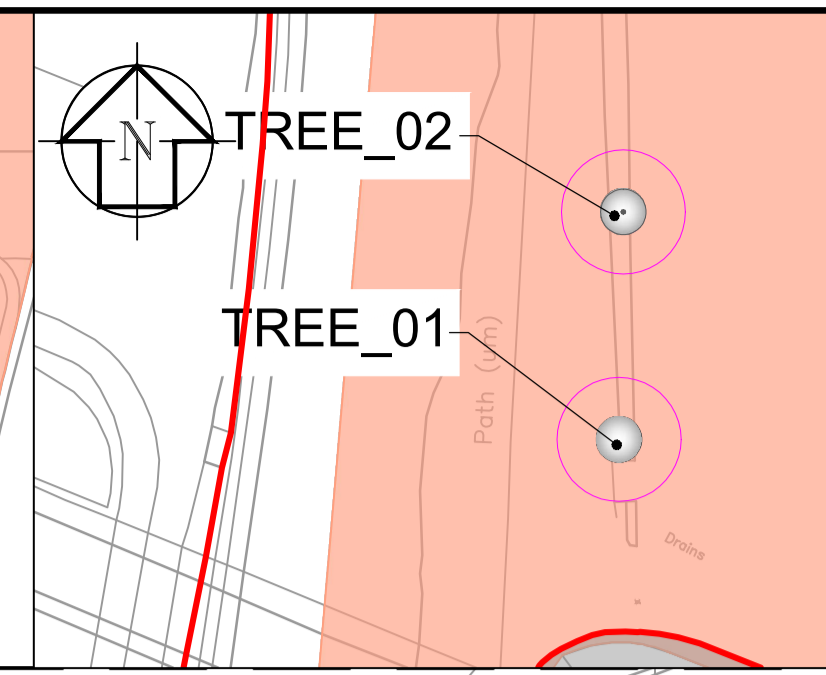
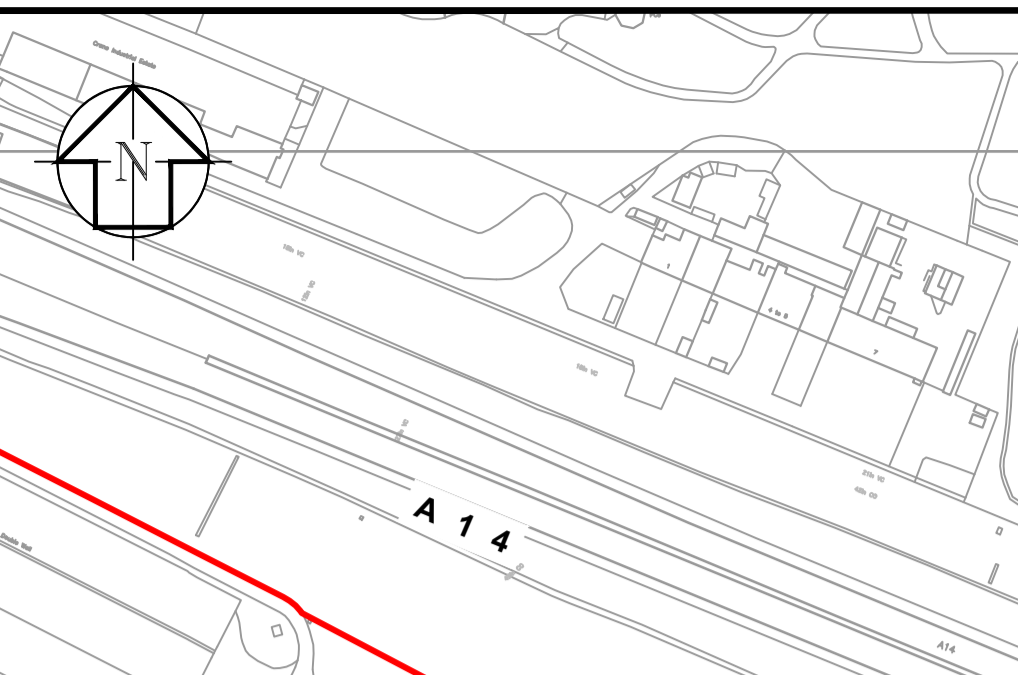
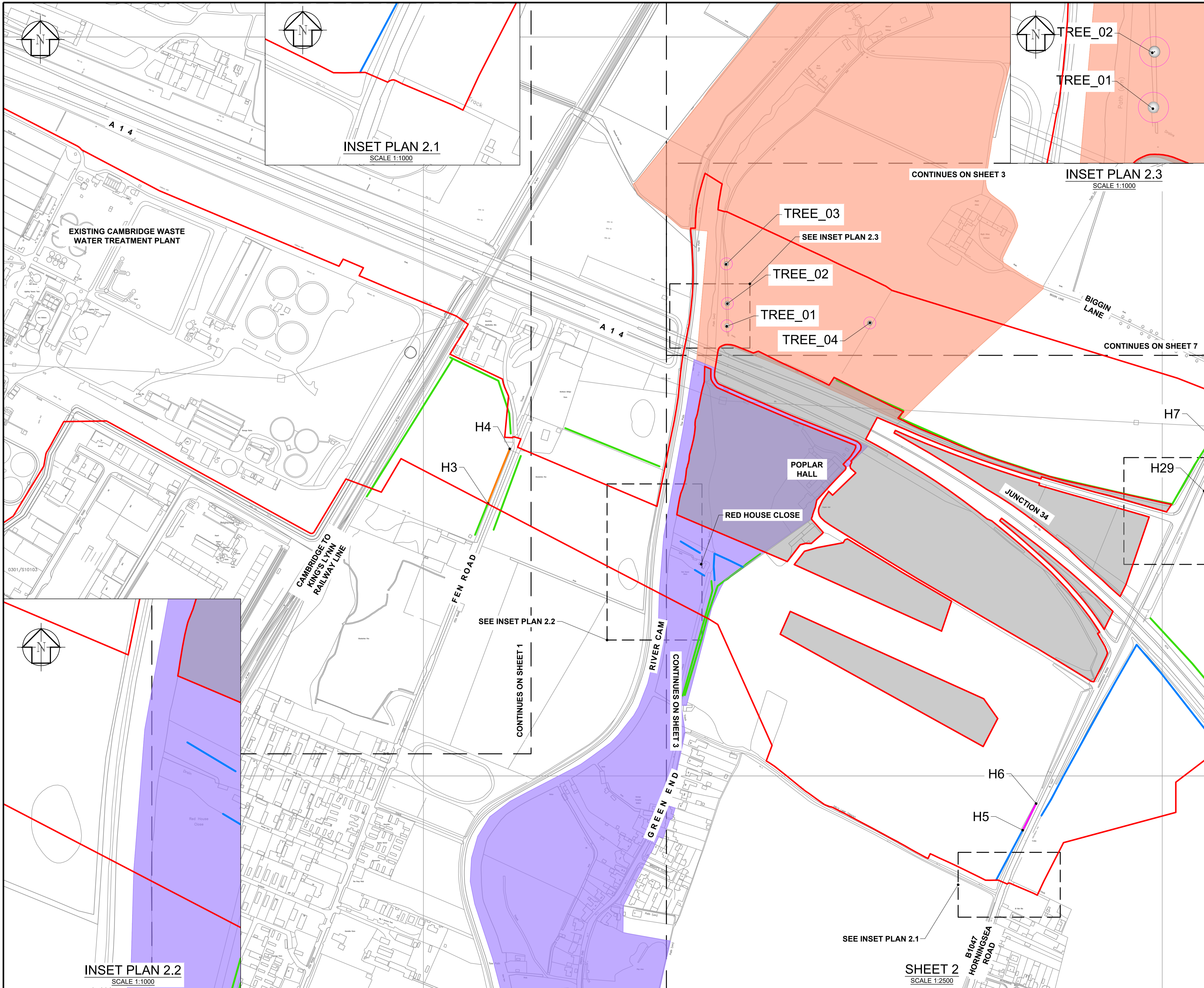

DES'D: -	DATE: 28/03/24	SCALE: AS SHOWN @A1
DRAWN: DP	DATE: 28/03/24	
CHK'D: MR	DATE: 28/03/24	
APP'D: MH	DATE: 28/03/24	
REV	DATE	DETAILS
C02	28/03/24	UPDATED FOR EXAMINATION DEADLINE 6
C01	20/01/23	FOR DCO SUBMISSION
STAT BY	CHK	APP
S4	DP	MR
S4	JL	MR
S4	JL	MH

PROJECT TITLE  
**CAMBRIDGE WASTE WATER TREATMENT PLANT RELOCATION PROJECT**

DRAWING TITLE  
**4.8.2 HEDGEROW REGULATIONS AND TREE PRESERVATION PLANS SHEET 2**  
 REGULATION 5(2)(I)(ii) & 5(2)(o)



The plan is produced by Anglian Water Services Limited, from Ordnance Survey Crown Copyright, Licence 100022432. This map is to be used for the purposes of viewing the location of Anglian Water plant only. Any other use of the map data or further copies are not permitted. This notice is not intended to exclude or restrict liability for death or personal injury resulting from negligence. The original document stored in the BIM 360 Doc Project carry the version, suitability code, revision and approval information. Prints are uncontrolled and shall not be used for construction.

DRAWING No. **00001-100006-CAMEST-ZZZ-LAY-Z-9022**

REV. STAT. **A1**  
**C02 S4**



GENERAL NOTES

1. THESE PLANS SHOULD BE READ IN CONJUNCTION WITH SCHEDULE 15 (REMOVAL OF HEDGEROWS) TO THE DRAFT DEVELOPMENT CONSENT ORDER (APPLICATION DOCUMENT REFERENCE: 2.1) AND THE WORKS PLANS (APPLICATION DOCUMENT REFERENCE: 4.3)
2. THE LEGEND IS IDENTICAL ON ALL SHEETS OF THE HEDGEROW PLANS AND THEREFORE NOT ALL ITEMS DETAILED IN THE LEGEND ARE REPRESENTED ON EACH SHEET.

LEGEND

- SCHEME ORDER LIMITS
- LAND OUTSIDE ORDER LIMITS
- HEDGEROW RETAINED
- HEDGEROW REMOVED
- IMPORTANT HEDGEROW RETAINED
- IMPORTANT HEDGEROW REMOVED
- ▭ CONSERVATION AREA BAITS BITE LOCK
- ▭ CONSERVATION AREA FEN DITTON
- ⊙ INDIVIDUAL TREE REMOVED
- H#** START & END POINT OF HEDGEROW TO BE REMOVED

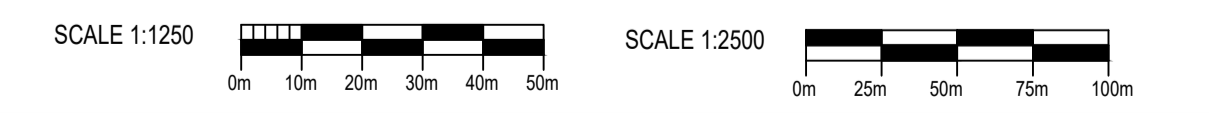
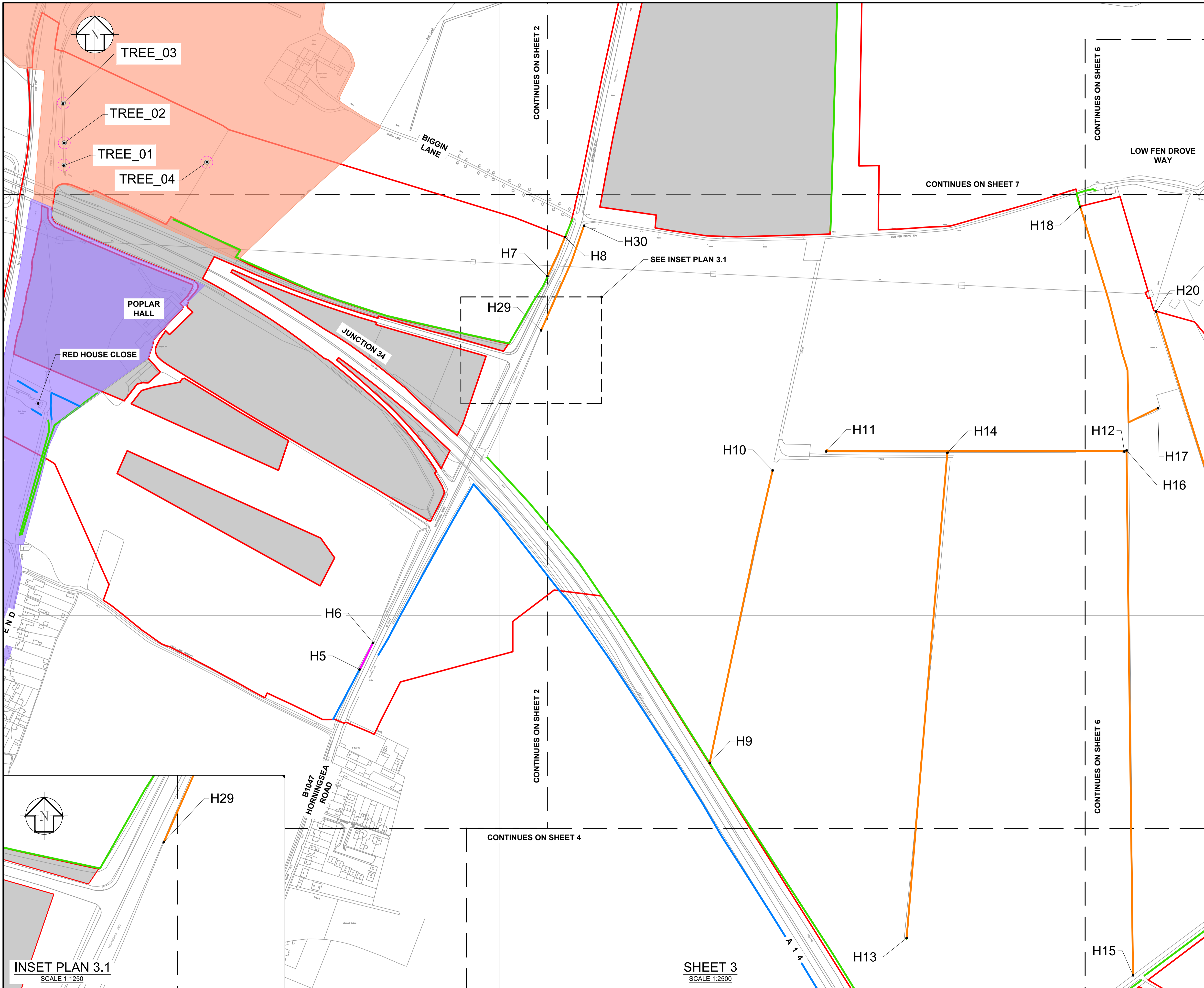

DES'D: -	DATE: 28/03/24	SCALE: AS SHOWN @A1
DRAWN: DP	DATE: 28/03/24	
CHK'D: MR	DATE: 28/03/24	
APP'D: MH	DATE: 28/03/24	
REV	DATE	DETAILS
C03	28/03/24	UPDATED FOR EXAMINATION DEADLINE 6
C02	14/02/24	FOR DCO EXAMINATION
C01	20/01/23	FOR DCO SUBMISSION
STAT	BY	CHK
S4	DP	MR
S4	TRJ	MR
S4	JL	MR
S4	JL	MR

PROJECT TITLE  
**CAMBRIDGE WASTE WATER TREATMENT PLANT RELOCATION PROJECT**

DRAWING TITLE  
**4.8.3 HEDGEROW REGULATIONS AND TREE PRESERVATION PLANS SHEET 3 REGULATION 5(2)(I)(ii) & 5(2)(o)**



The plan is produced by Anglian Water Services Limited, from Ordnance Survey Crown Copyright, Licence 100022432. This map is to be used for the purposes of viewing the location of Anglian Water plant only. Any other use of the map data or further copies are not permitted. This notice is not intended to exclude or restrict liability for death or personal injury resulting from negligence. The original document stored in the BIM 360 Doc Project carry the version, suitability code, revision and approval information. Prints are uncontrolled and shall not be used for construction.

DRAWING No. **00001-100006-CAMEST-ZZZ-LAY-Z-9023**

REV. STAT. **A1**  
**C03 S4**



**APPLICATION DOCUMENT REFERENCE 4.8.4**

**GENERAL NOTES**

1. THESE PLANS SHOULD BE READ IN CONJUNCTION WITH SCHEDULE 15 (REMOVAL OF HEDGEROWS) TO THE DRAFT DEVELOPMENT CONSENT ORDER (APPLICATION DOCUMENT REFERENCE: 2.1) AND THE WORKS PLANS (APPLICATION DOCUMENT REFERENCE: 4.3)
2. THE LEGEND IS IDENTICAL ON ALL SHEETS OF THE HEDGEROW PLANS AND THEREFORE NOT ALL ITEMS DETAILED IN THE LEGEND ARE REPRESENTED ON EACH SHEET.

**LEGEND**

- SCHEME ORDER LIMITS
- LAND OUTSIDE ORDER LIMITS
- HEDGEROW RETAINED
- HEDGEROW REMOVED
- IMPORTANT HEDGEROW RETAINED
- IMPORTANT HEDGEROW REMOVED
- CONSERVATION AREA BAITS BITE LOCK
- CONSERVATION AREA FEN DITTON
- INDIVIDUAL TREE REMOVED
- H#** START & END POINT OF HEDGEROW TO BE REMOVED

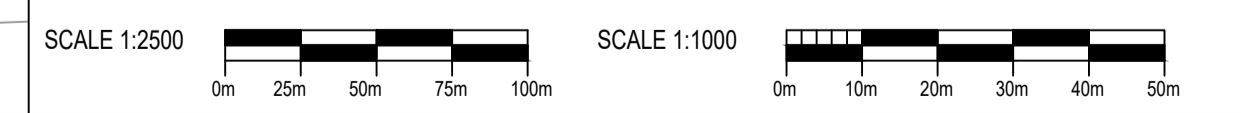
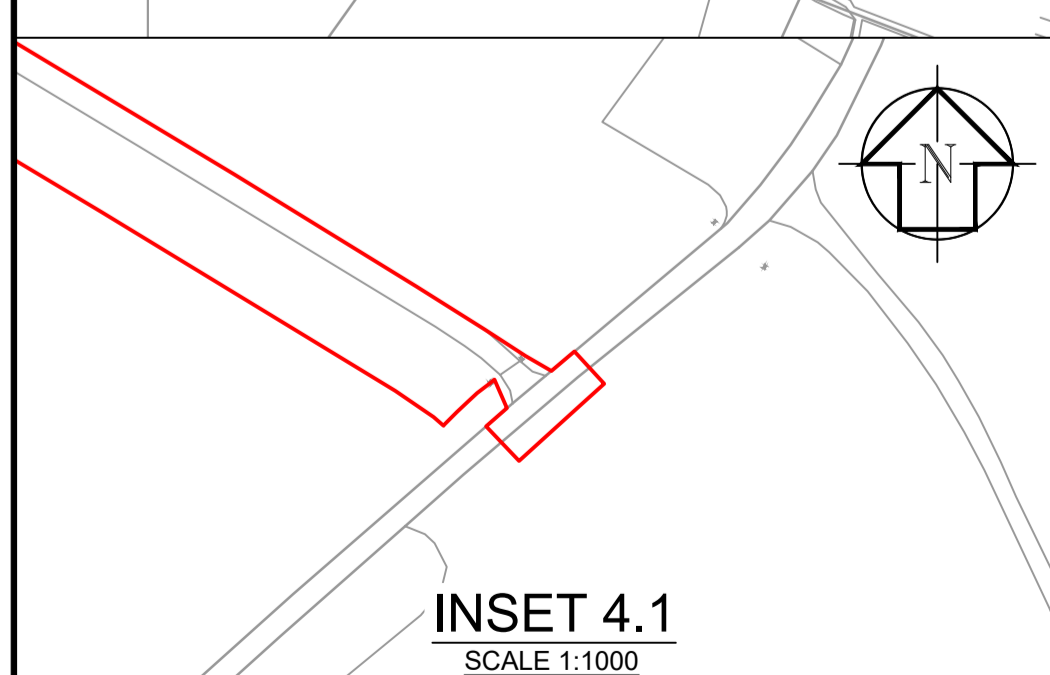
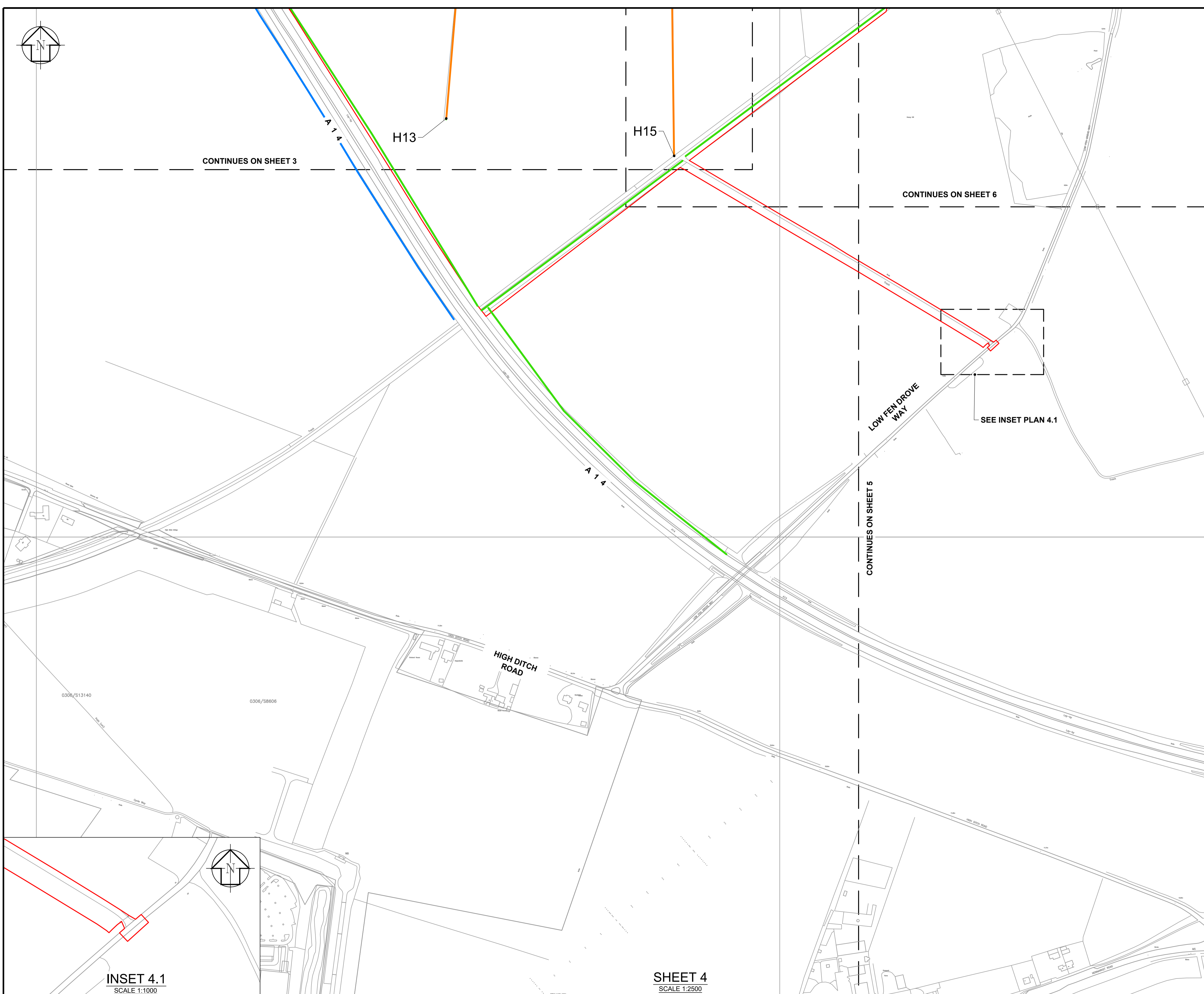

DES'D: -	DATE: 28/03/24	SCALE: AS SHOWN @A1
DRAWN: DP	DATE: 28/03/24	
CHK'D: MR	DATE: 28/03/24	
APP'D: MH	DATE: 28/03/24	
STAT BY	CHK	APP

PROJECT TITLE  
**CAMBRIDGE WASTE WATER TREATMENT PLANT RELOCATION PROJECT**

DRAWING TITLE  
**4.8.4 HEDGEROW REGULATIONS AND TREE PRESERVATION PLANS SHEET 4 REGULATION 5(2)(I)(ii) & 5(2)(o)**



The plan is produced by Anglian Water Services Limited, from Ordnance Survey Crown Copyright, Licence 100022432. This map is to be used for the purposes of viewing the location of Anglian Water plant only. Any other use of the map data or further copies are not permitted. This notice is not intended to exclude or restrict liability for death or personal injury resulting from negligence. The original document stored in the BIM 360 Doc Project carry the version, suitability code, revision and approval information. Prints are uncontrolled and shall not be used for construction.

DRAWING No. **00001-100006-CAMEST-ZZZ-LAY-Z-9024**

REV. STAT. **A1**  
**C03 S4**



GENERAL NOTES

1. THESE PLANS SHOULD BE READ IN CONJUNCTION WITH SCHEDULE 15 (REMOVAL OF HEDGEROWS) TO THE DRAFT DEVELOPMENT CONSENT ORDER (APPLICATION DOCUMENT REFERENCE: 2.1) AND THE WORKS PLANS (APPLICATION DOCUMENT REFERENCE: 4.3)
2. THE LEGEND IS IDENTICAL ON ALL SHEETS OF THE HEDGEROW PLANS AND THEREFORE NOT ALL ITEMS DETAILED IN THE LEGEND ARE REPRESENTED ON EACH SHEET.

LEGEND

- SCHEME ORDER LIMITS
- LAND OUTSIDE ORDER LIMITS
- HEDGEROW RETAINED
- HEDGEROW REMOVED
- IMPORTANT HEDGEROW RETAINED
- IMPORTANT HEDGEROW REMOVED
- CONSERVATION AREA BAITS BITE LOCK
- CONSERVATION AREA FEN DITTON
- INDIVIDUAL TREE REMOVED
- H#** START & END POINT OF HEDGEROW TO BE REMOVED

**NO HEDGEROWS  
AFFECTED HERE  
DRAWING INCLUDED FOR  
COMPLETENESS**

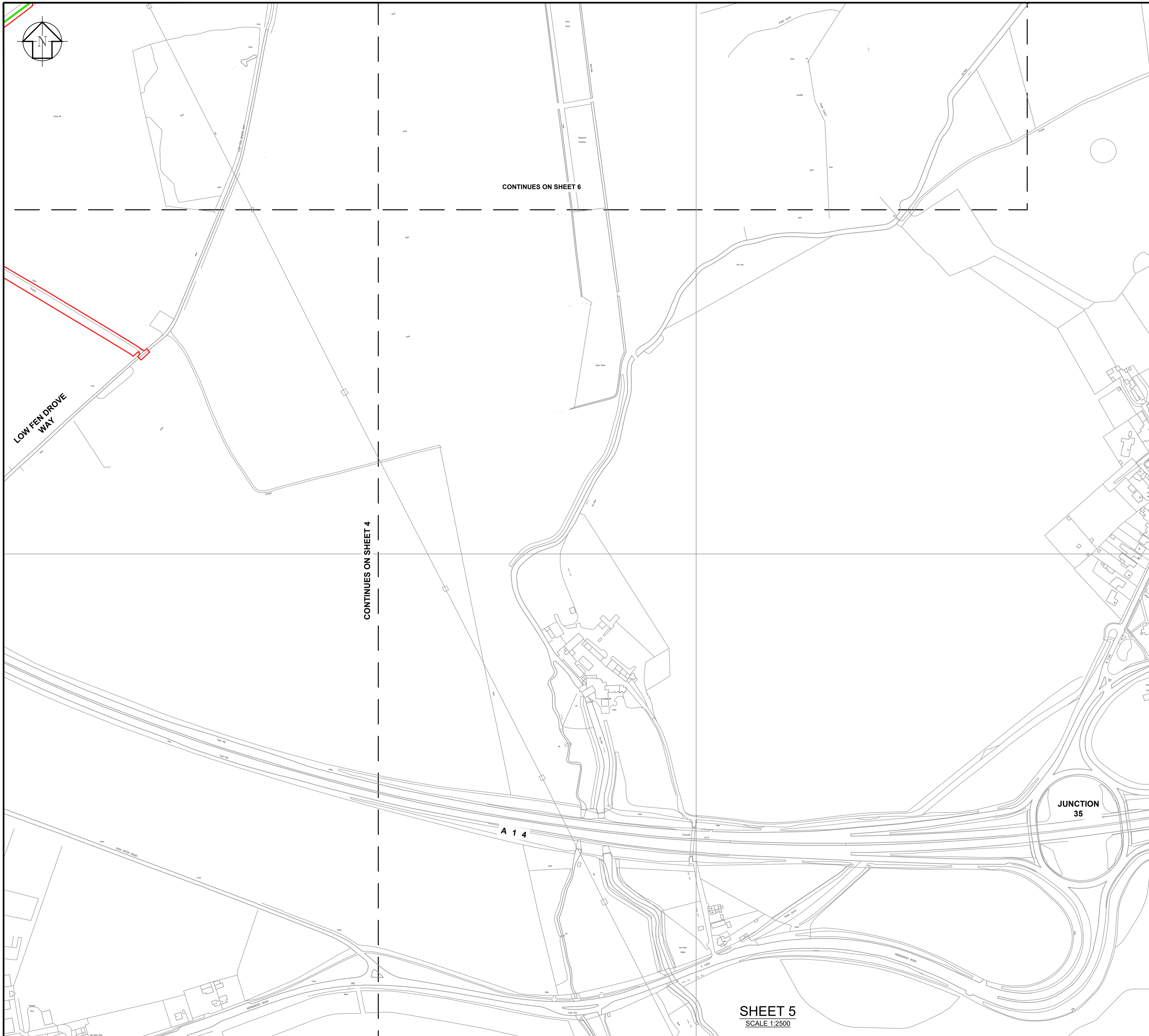
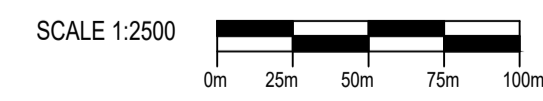

SHEET 5  
SCALE 1:2500

END OF TITLE

DES'D: -	DATE: 28/03/24	SCALE: AS SHOWN @A1	PROJECT TITLE	DRAWING TITLE	<p>Anglian Water Services Ltd, Lancaster House, Lancaster Way, Ermine Business Park, Huntingdon, PE29 6XU Tel: 01480 323000 www.anglianwater.co.uk</p>	The plan is produced by Anglian Water Services Limited, from Ordnance Survey Crown Copyright, Licence 100022432. This map is to be used for the purposes of viewing the location of Anglian Water plant only. Any other use of the map data or further copies are not permitted. This notice is not intended to exclude or restrict liability for death or personal injury resulting from negligence. The original document stored in the BIM 360 Doc Project carry the version, suitability code, revision and approval information. Prints are uncontrolled and shall not be used for construction.	DRAWING No. 00001-100006-CAMEST-ZZZ-LAY-Z-9025	REV.	STAT.			
C03	28/03/24	UPDATED FOR EXAMINATION DEADLINE 6	S4	DP				MR	MH	DRAWN: DP	DATE: 28/03/24	<b>A1</b>
C02	14/02/24	FOR DCO EXAMINATION	S4	TR1				MR	MH	CHK'D: MR	DATE: 28/03/24	
C01	20/01/23	FOR DCO SUBMISSION	S4	JL				MR	MH	APP'D: MH	DATE: 28/03/24	
REV	DATE	DETAILS	STAT	BY	CHK	APP						

**CAMBRIDGE WASTE WATER  
TREATMENT PLANT  
RELOCATION PROJECT**

**4.8.5 HEDGEROW REGULATIONS  
AND TREE PRESERVATION  
PLANS SHEET 5  
REGULATION 5(2)(I)(ii) & 5(2)(o)**

REV. C03 STAT. S4



GENERAL NOTES

1. THESE PLANS SHOULD BE READ IN CONJUNCTION WITH SCHEDULE 15 (REMOVAL OF HEDGEROWS) TO THE DRAFT DEVELOPMENT CONSENT ORDER (APPLICATION DOCUMENT REFERENCE: 2.1) AND THE WORKS PLANS (APPLICATION DOCUMENT REFERENCE: 4.3)
2. THE LEGEND IS IDENTICAL ON ALL SHEETS OF THE HEDGEROW PLANS AND THEREFORE NOT ALL ITEMS DETAILED IN THE LEGEND ARE REPRESENTED ON EACH SHEET.

LEGEND

- SCHEME ORDER LIMITS
- LAND OUTSIDE ORDER LIMITS
- HEDGEROW RETAINED
- HEDGEROW REMOVED
- IMPORTANT HEDGEROW RETAINED
- IMPORTANT HEDGEROW REMOVED
- CONSERVATION AREA BAITS BITE LOCK
- CONSERVATION AREA FEN DITTON
- INDIVIDUAL TREE REMOVED
- H#** START & END POINT OF HEDGEROW TO BE REMOVED

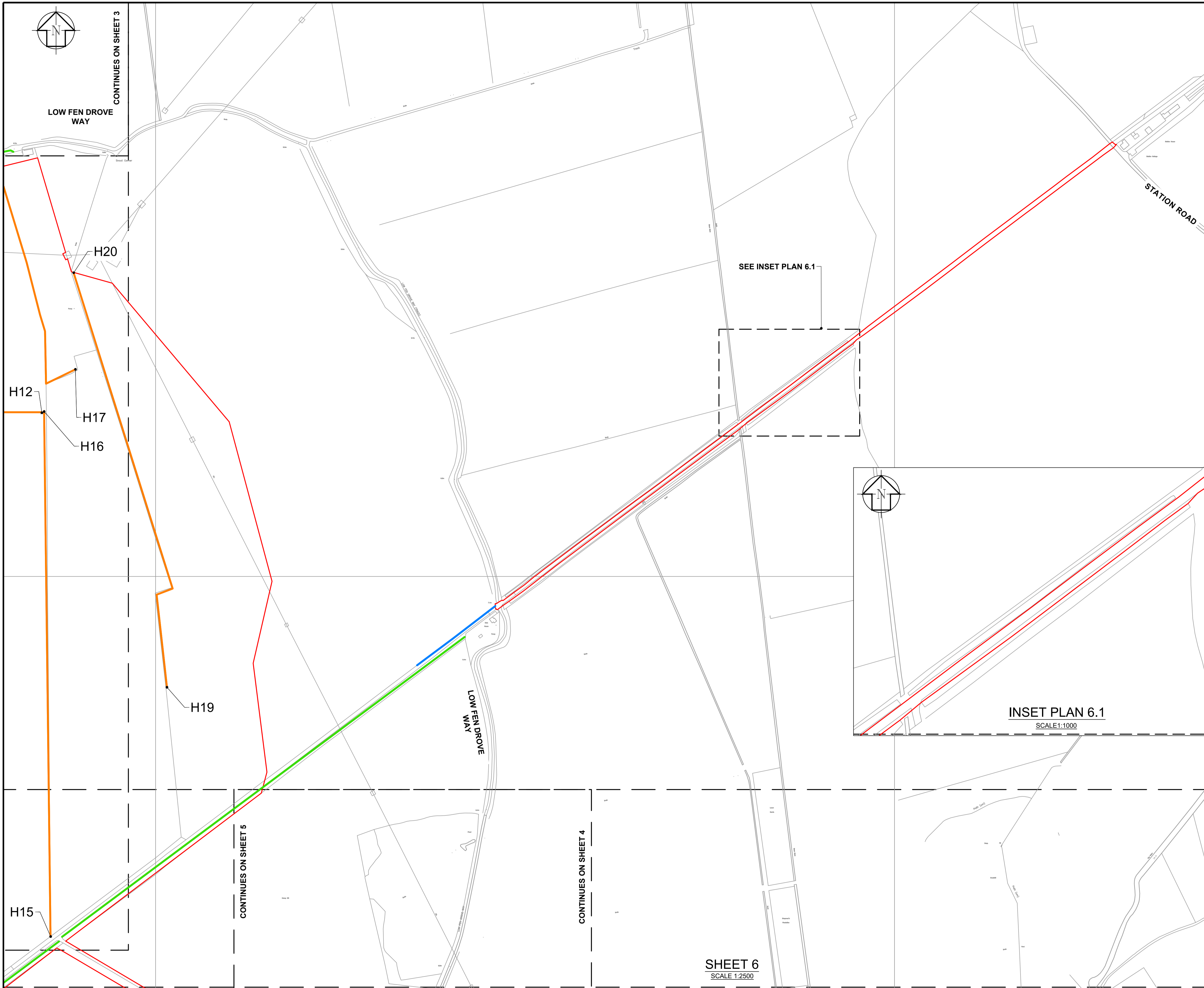

SEE INSET PLAN 6.1

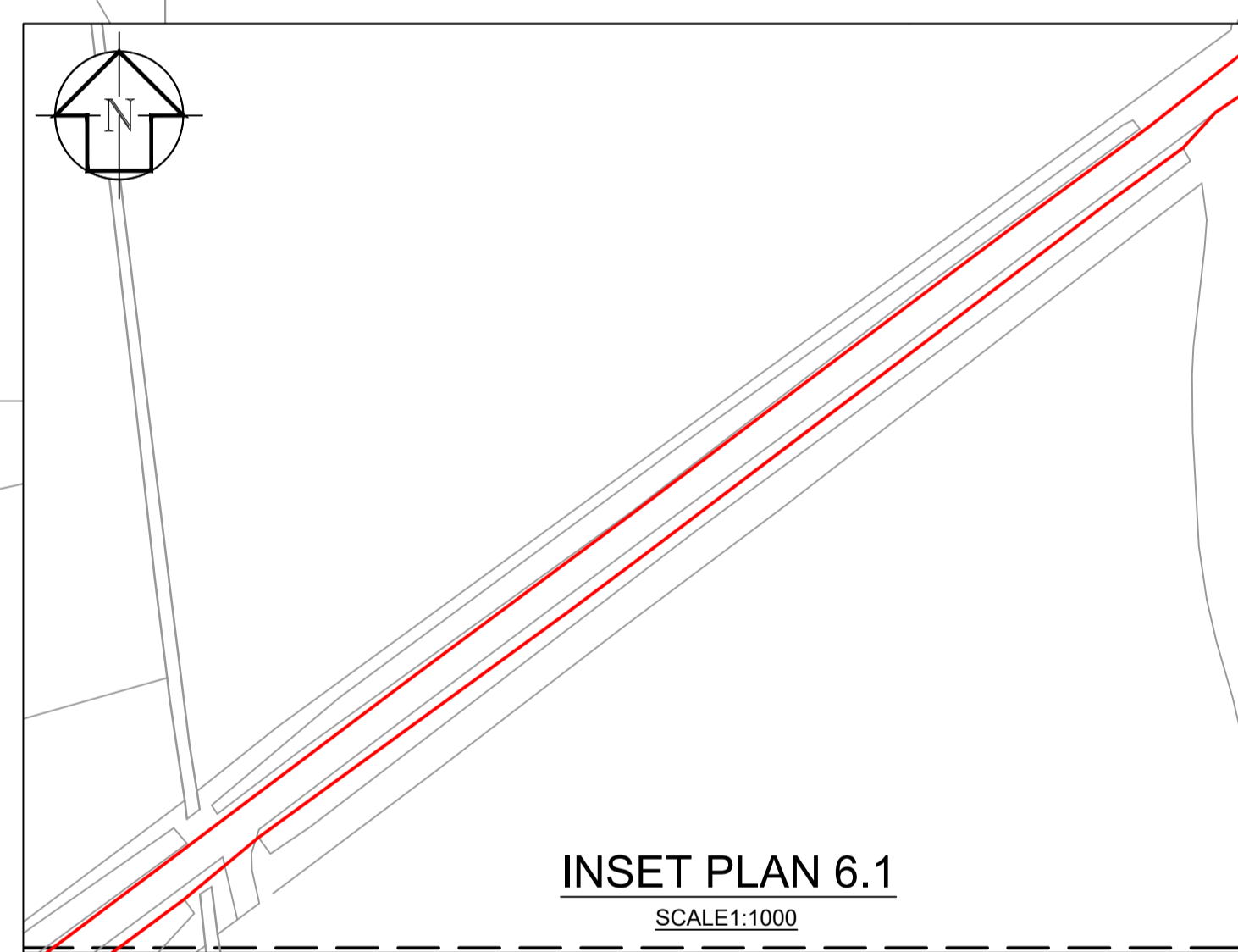

**SHEET 6**  
SCALE 1:2500

SCALE 1:2500 SCALE 1:1000

REV	DATE	DETAILS	STAT	BY	CHK	APP
C03	28/03/24	UPDATED FOR EXAMINATION DEADLINE 6	S4	DP	MR	MH
C02	14/02/24	FOR DCO EXAMINATION	S4	TRI	MR	MH
C01	20/01/23	FOR DCO SUBMISSION	S4	JL	MR	MH

DES'D: -	DATE: 28/03/24	SCALE: AS SHOWN @A1
DRAWN: DP	DATE: 28/03/24	
CHK'D: MR	DATE: 28/03/24	
APP'D: MH	DATE: 28/03/24	

PROJECT TITLE  
**CAMBRIDGE WASTE WATER TREATMENT PLANT RELOCATION PROJECT**

DRAWING TITLE  
**4.8.6 HEDGEROW REGULATIONS AND TREE PRESERVATION PLANS SHEET 6 REGULATION 5(2)(I)(ii) & 5(2)(o)**



The plan is produced by Anghian Water Services Limited, from Ordnance Survey Crown Copyright, Licence 100022432. This map is to be used for the purposes of viewing the location of Anghian Water plant only. Any other use of the map data or further copies are not permitted. This notice is not intended to exclude or restrict liability for death or personal injury resulting from negligence. The original document stored in the BIM 360 Doc Project carry the version, suitability code, revision and approval information. Prints are uncontrolled and shall not be used for construction.

DRAWING No. **00001-100006-CAMEST-ZZZ-LAY-Z-9026**

DRAWING SIZE: **A1**  
REV. STAT. **C03 S4**



GENERAL NOTES

1. THESE PLANS SHOULD BE READ IN CONJUNCTION WITH SCHEDULE 15 (REMOVAL OF HEDGEROWS) TO THE DRAFT DEVELOPMENT CONSENT ORDER (APPLICATION DOCUMENT REFERENCE: 2.1) AND THE WORKS PLANS (APPLICATION DOCUMENT REFERENCE: 4.3)
2. THE LEGEND IS IDENTICAL ON ALL SHEETS OF THE HEDGEROW PLANS AND THEREFORE NOT ALL ITEMS DETAILED IN THE LEGEND ARE REPRESENTED ON EACH SHEET.

LEGEND

- SCHEME ORDER LIMITS
- LAND OUTSIDE ORDER LIMITS
- HEDGEROW RETAINED
- HEDGEROW REMOVED
- IMPORTANT HEDGEROW RETAINED
- IMPORTANT HEDGEROW REMOVED
- CONSERVATION AREA BAITS BITE LOCK
- CONSERVATION AREA FEN DITTON
- INDIVIDUAL TREE REMOVED
- H#** START & END POINT OF HEDGEROW TO BE REMOVED

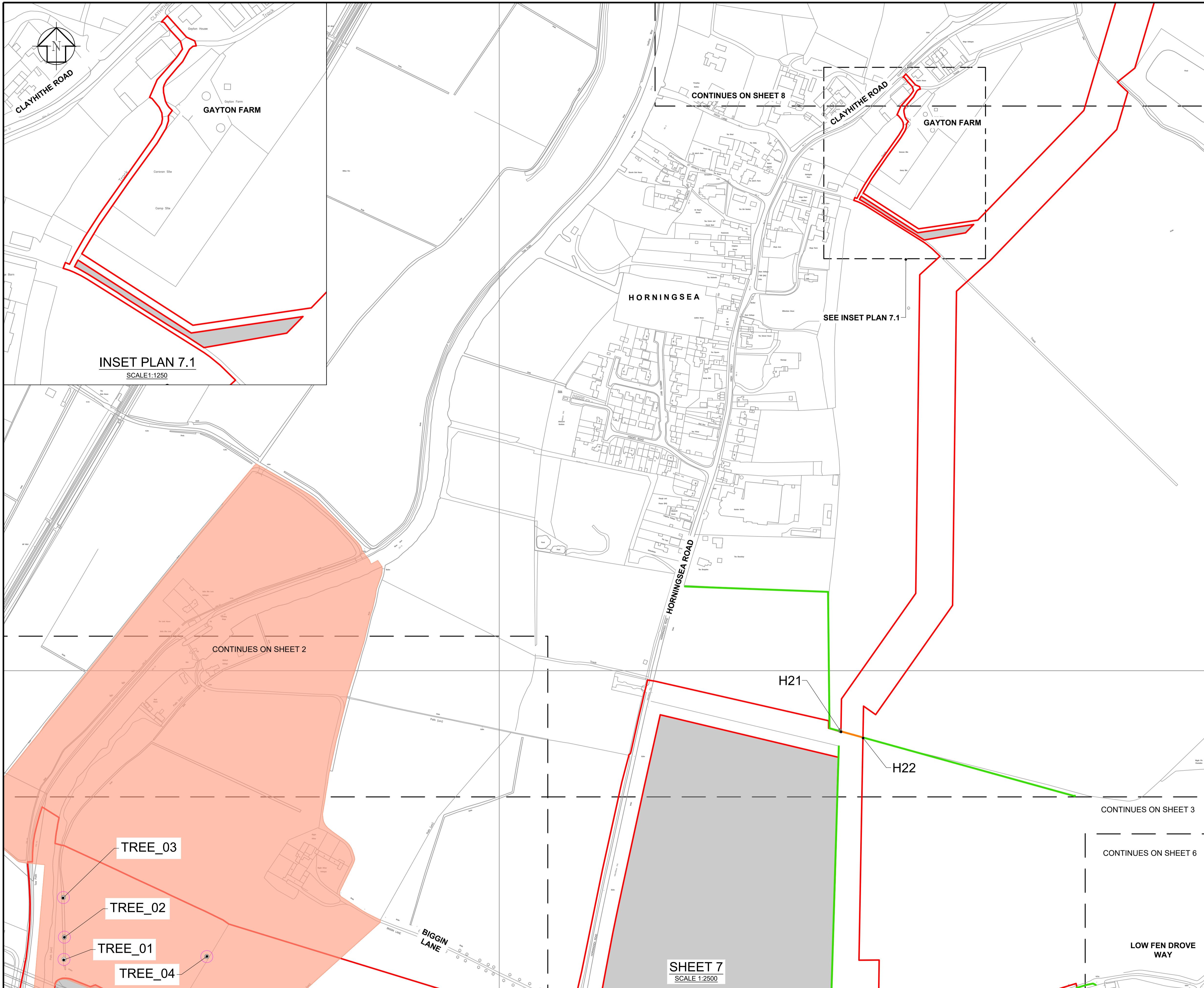

INSET PLAN 7.1  
SCALE 1:1250

SHEET 7  
SCALE 1:2500

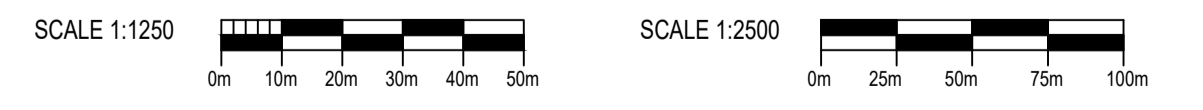

DES'D: -	DATE: 28/03/24	SCALE: AS SHOWN @A1
DRAWN: DP	DATE: 28/03/24	
CHK'D: MR	DATE: 28/03/24	
APP'D: MH	DATE: 28/03/24	
REV	DATE	DETAILS
C03	28/03/24	UPDATED FOR EXAMINATION DEADLINE 6
C02	14/02/24	FOR DCO EXAMINATION
C01	20/01/23	FOR DCO SUBMISSION
STAT	BY	CHK
S4	DP	MR
S4	TR	MR
S4	JL	MR
APP	CHK	APP

PROJECT TITLE  
**CAMBRIDGE WASTE WATER TREATMENT PLANT RELOCATION PROJECT**

DRAWING TITLE  
**4.8.7 HEDGEROW REGULATIONS AND TREE PRESERVATION PLANS SHEET 7 REGULATION 5(2)(I)(ii) & 5(2)(o)**



The plan is produced by Anglian Water Services Limited, from Ordnance Survey Crown Copyright, Licence 100022432. This map is to be used for the purposes of viewing the location of Anglian Water plant only. Any other use of the map data or further copies are not permitted. This notice is not intended to exclude or restrict liability for death or personal injury resulting from negligence. The original document stored in the BIM 360 Doc Project carry the version, suitability code, revision and approval information. Prints are uncontrolled and shall not be used for construction.

DRAWING No. **00001-100006-CAMEST-ZZZ-LAY-Z-9027**

REV. STAT. **A1**  
C03 S4



GENERAL NOTES

1. THESE PLANS SHOULD BE READ IN CONJUNCTION WITH SCHEDULE 15 (REMOVAL OF HEDGEROWS) TO THE DRAFT DEVELOPMENT CONSENT ORDER (APPLICATION DOCUMENT REFERENCE: 2.1) AND THE WORKS PLANS (APPLICATION DOCUMENT REFERENCE: 4.3)
2. THE LEGEND IS IDENTICAL ON ALL SHEETS OF THE HEDGEROW PLANS AND THEREFORE NOT ALL ITEMS DETAILED IN THE LEGEND ARE REPRESENTED ON EACH SHEET.

LEGEND

- SCHEME ORDER LIMITS
- LAND OUTSIDE ORDER LIMITS
- HEDGEROW RETAINED
- HEDGEROW REMOVED
- IMPORTANT HEDGEROW RETAINED
- IMPORTANT HEDGEROW REMOVED
- CONSERVATION AREA BAITS BITE LOCK
- CONSERVATION AREA FEN DITTON
- ⊙ INDIVIDUAL TREE REMOVED
- H#** START & END POINT OF HEDGEROW TO BE REMOVED

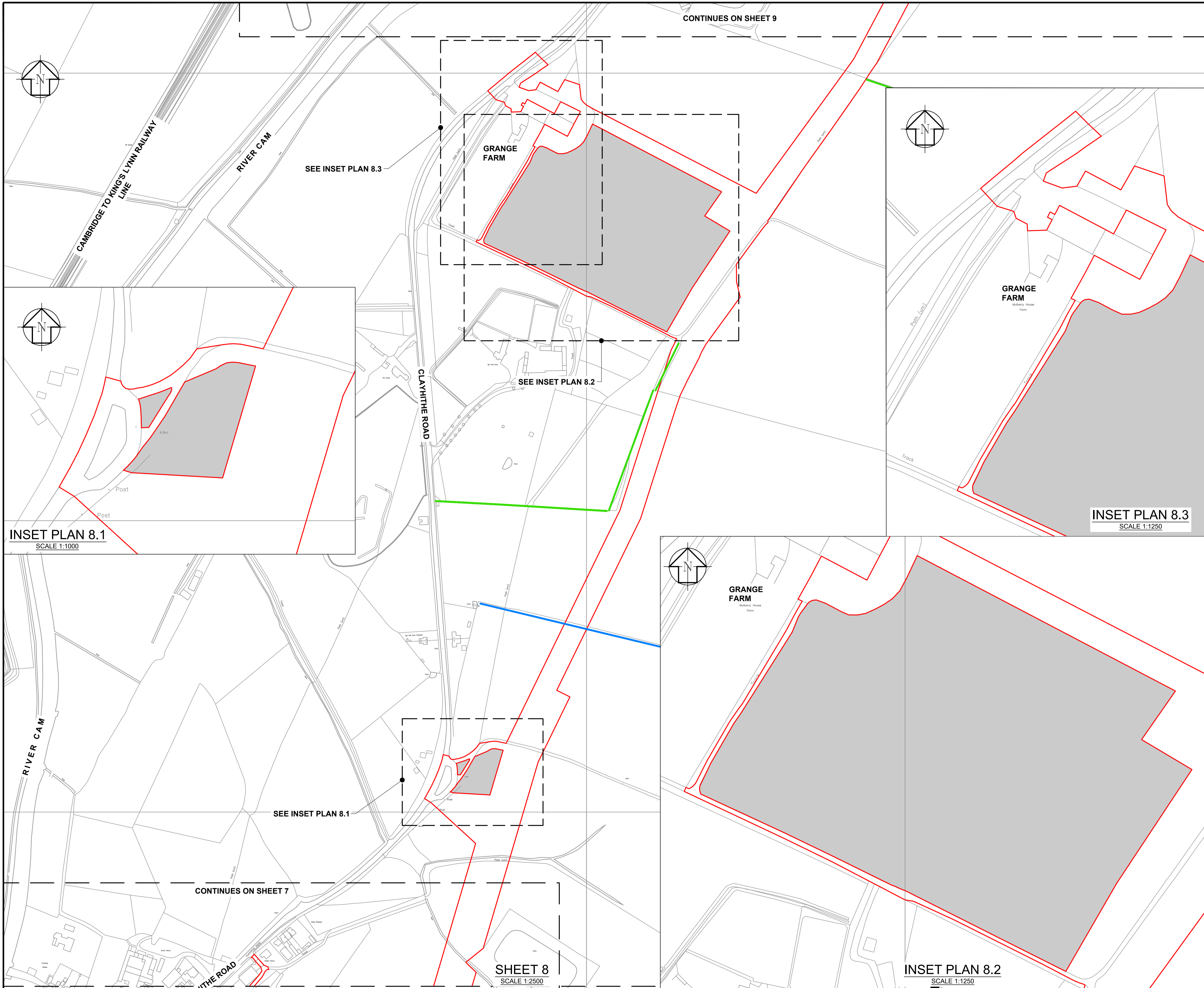

INSET PLAN 8.1  
SCALE 1:1000

INSET PLAN 8.3  
SCALE 1:1250

INSET PLAN 8.2  
SCALE 1:1250

SHEET 8  
SCALE 1:2500

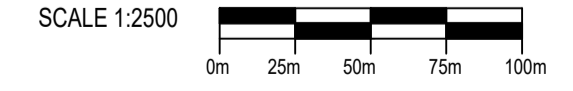
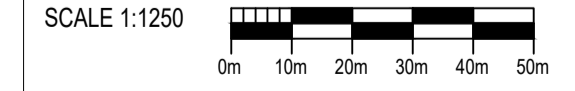
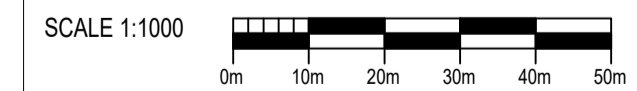

REV	DATE	DETAILS	STAT	BY	CHK	APP	DES'D: -	DATE: 28/03/24	SCALE: AS SHOWN @A1
C03	28/03/24	UPDATED FOR EXAMINATION DEADLINE 6	S4	DP	MR	MH	DRAWN: DP	DATE: 28/03/24	
C02	17/01/24	UPDATED HEDGEROWS FOR DCO SUBMISSION	S4	SC	MR	MH	CHK'D: MR	DATE: 28/03/24	
C01	20/01/23	FOR DCO SUBMISSION	S4	JL	MR	MH	APP'D: MH	DATE: 28/03/24	

PROJECT TITLE  
**CAMBRIDGE WASTE WATER TREATMENT PLANT RELOCATION PROJECT**

DRAWING TITLE  
**4.8.8 HEDGEROW REGULATIONS AND TREE PRESERVATION PLANS SHEET 8**

REGULATION 5(2)(I)(ii) & 5(2)(o)



The plan is produced by Anglian Water Services Limited, from Ordnance Survey Crown Copyright, Licence 100022432. This map is to be used for the purposes of viewing the location of Anglian Water plant only. Any other use of the map data or further copies are not permitted. This notice is not intended to exclude or restrict liability for death or personal injury resulting from negligence. The original document stored in the BIM 360 Doc Project carry the version, suitability code, revision and approval information. Prints are uncontrolled and shall not be used for construction.

DRAWING No. **00001-100006-CAMEST-ZZZ-LAY-Z-9028**

DRAWING SIZE: **A1**  
REV. **C03** STAT. **S4**



GENERAL NOTES

1. THESE PLANS SHOULD BE READ IN CONJUNCTION WITH SCHEDULE 15 (REMOVAL OF HEDGEROWS) TO THE DRAFT DEVELOPMENT CONSENT ORDER (APPLICATION DOCUMENT REFERENCE: 2.1) AND THE WORKS PLANS (APPLICATION DOCUMENT REFERENCE: 4.3)
2. THE LEGEND IS IDENTICAL ON ALL SHEETS OF THE HEDGEROW PLANS AND THEREFORE NOT ALL ITEMS DETAILED IN THE LEGEND ARE REPRESENTED ON EACH SHEET.

LEGEND

- SCHEME ORDER LIMITS
- LAND OUTSIDE ORDER LIMITS
- HEDGEROW RETAINED
- HEDGEROW REMOVED
- IMPORTANT HEDGEROW RETAINED
- IMPORTANT HEDGEROW REMOVED
- CONSERVATION AREA BAITS BITE LOCK
- CONSERVATION AREA FEN DITTON
- INDIVIDUAL TREE REMOVED
- H#** START & END POINT OF HEDGEROW TO BE REMOVED

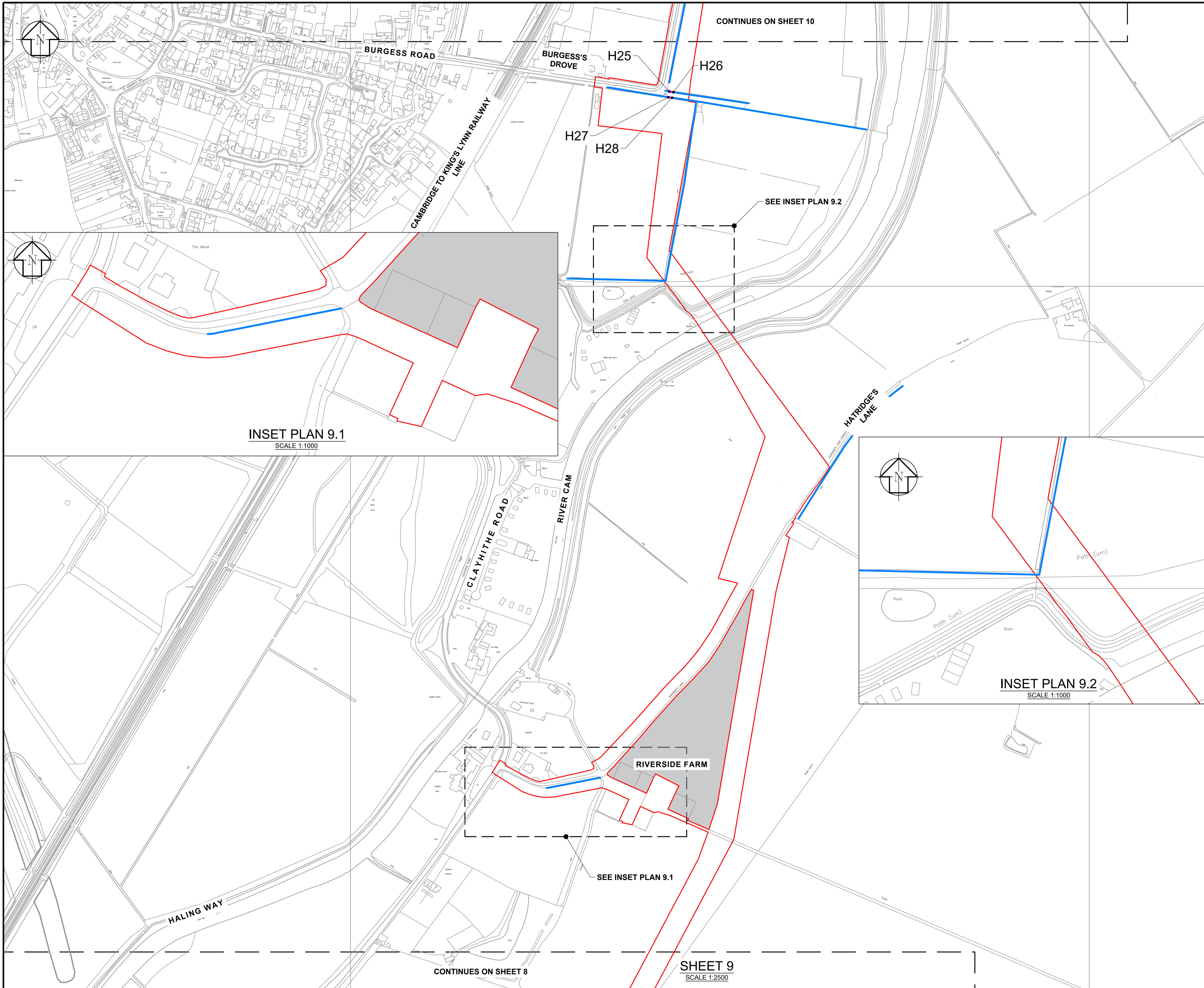

INSET PLAN 9.1  
SCALE 1:1000

INSET PLAN 9.2  
SCALE 1:1000

SHEET 9  
SCALE 1:2500

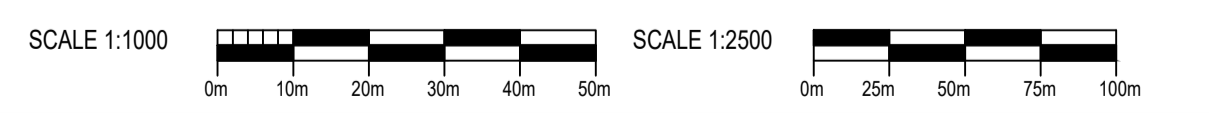

DES'D: -	DATE: 28/03/24	SCALE: AS SHOWN @A1
DRAWN: DP	DATE: 28/03/24	
CHK'D: MR	DATE: 28/03/24	
APP'D: MH	DATE: 28/03/24	
REV	DATE	DETAILS
S4	DP	MR
S4	TR	MR
S4	JL	MR
STAT	BY	CHK
	APP	

PROJECT TITLE  
**CAMBRIDGE WASTE WATER TREATMENT PLANT RELOCATION PROJECT**

DRAWING TITLE  
**4.8.9 HEDGEROW REGULATIONS AND TREE PRESERVATION PLANS SHEET 9 REGULATION 5(2)(I)(ii) & 5(2)(o)**



The plan is produced by Anglian Water Services Limited, from Ordnance Survey Crown Copyright, Licence 100022432. This map is to be used for the purposes of viewing the location of Anglian Water plant only. Any other use of the map data or further copies are not permitted. This notice is not intended to exclude or restrict liability for death or personal injury resulting from negligence. The original document stored in the BIM 360 Doc Project carry the version, suitability code, revision and approval information. Prints are uncontrolled and shall not be used for construction.

DRAWING No. **00001-100006-CAMEST-ZZZ-LAY-Z-9029**

REV. STAT. **A1**  
**C03 S4**



GENERAL NOTES

1. THESE PLANS SHOULD BE READ IN CONJUNCTION WITH SCHEDULE 15 (REMOVAL OF HEDGEROWS) TO THE DRAFT DEVELOPMENT CONSENT ORDER (APPLICATION DOCUMENT REFERENCE: 2.1) AND THE WORKS PLANS (APPLICATION DOCUMENT REFERENCE: 4.3)
2. THE LEGEND IS IDENTICAL ON ALL SHEETS OF THE HEDGEROW PLANS AND THEREFORE NOT ALL ITEMS DETAILED IN THE LEGEND ARE REPRESENTED ON EACH SHEET.

LEGEND

- SCHEME ORDER LIMITS
- LAND OUTSIDE ORDER LIMITS
- HEDGEROW RETAINED
- HEDGEROW REMOVED
- IMPORTANT HEDGEROW RETAINED
- IMPORTANT HEDGEROW REMOVED
- CONSERVATION AREA BAITS BITE LOCK
- CONSERVATION AREA FEN DITTON
- INDIVIDUAL TREE REMOVED
- H#** START & END POINT OF HEDGEROW TO BE REMOVED

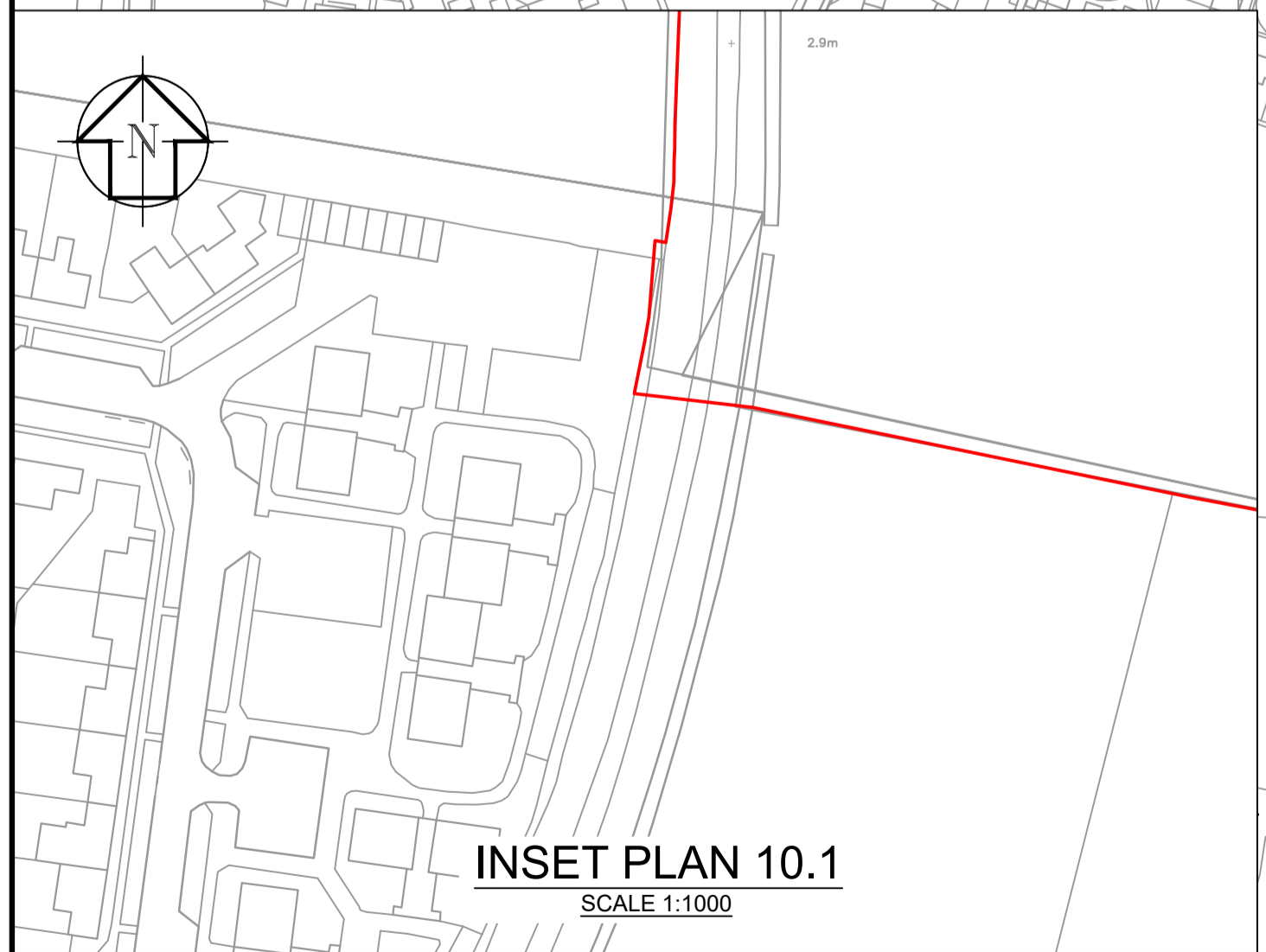
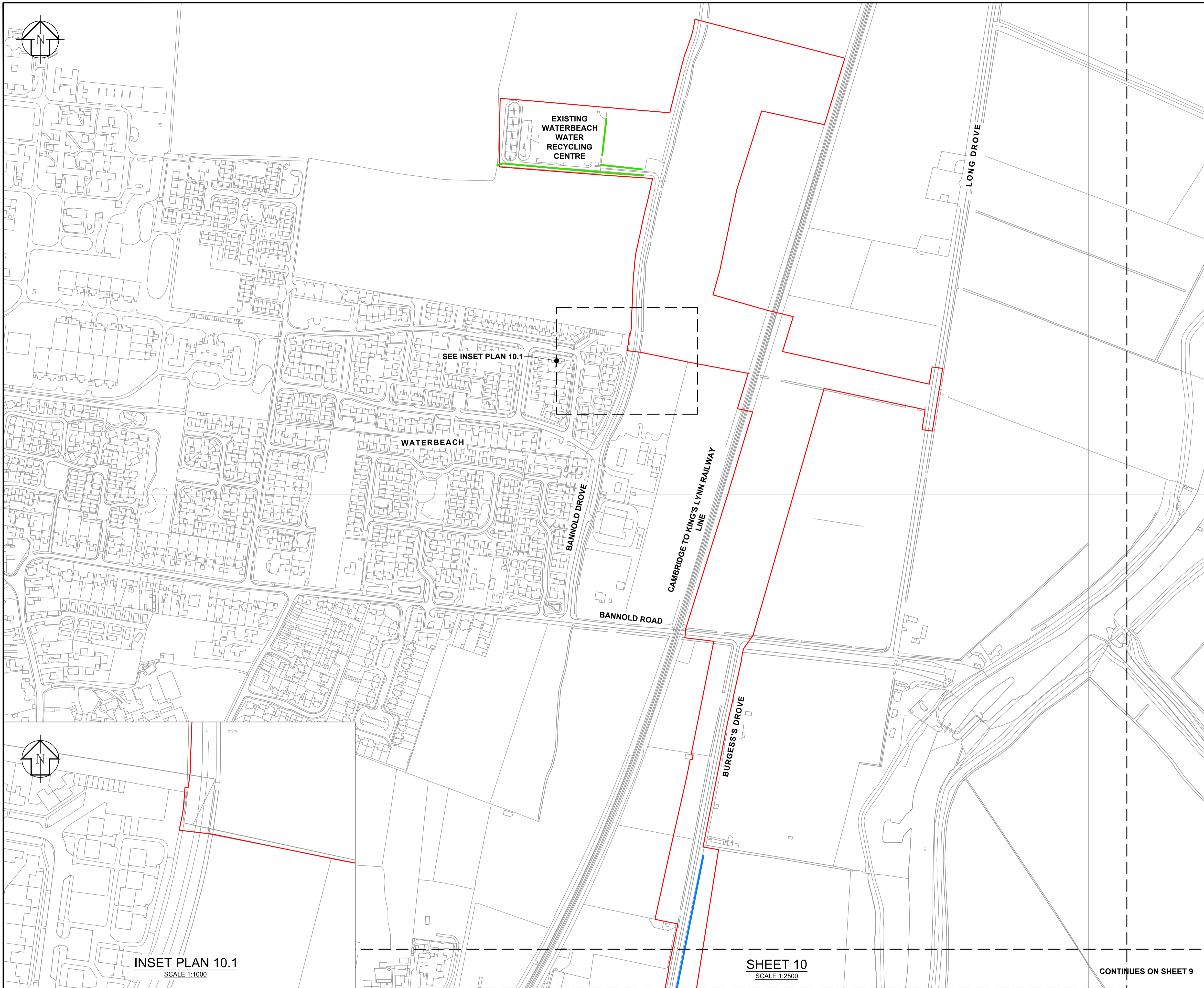

INSET PLAN 10.1  
SCALE 1:1000

SHEET 10  
SCALE 1:2500

CONTINUES ON SHEET 9

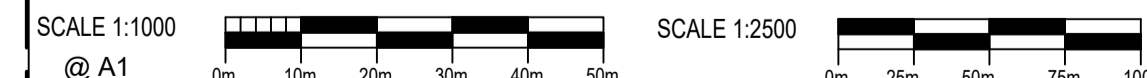

REV	DATE	DETAILS	STAT	BY	CHK	APP	DES'D: -	DATE: 28/03/24	SCALE: AS SHOWN @A1
C04	28/03/24	UPDATED FOR EXAMINATION DEADLINE 6	S4	DP	MR	MH	DRAWN: DP	DATE: 28/03/24	
C03	14/02/24	FOR DCO EXAMINATION	S4	TRi	MR	MH	CHK'D: MR	DATE: 28/03/24	
C02	29/09/23	FOR REVISED DCO SUBMISSION	S4	SC	AH	MR	APP'D: MH	DATE: 28/03/24	
C01	20/01/23	FOR DCO SUBMISSION	S4	JL	MR	MH			

PROJECT TITLE  
**CAMBRIDGE WASTE WATER TREATMENT PLANT RELOCATION PROJECT**

DRAWING TITLE  
**4.8.10 HEDGEROW REGULATIONS AND TREE PRESERVATION PLANS SHEET 10**  
REGULATION 5(2)(I)(ii) & 5(2)(o)

**anglianwater**  
Anglian Water Services Ltd, Lancaster House, Lancaster Way, Ermine Business Park, Huntingdon, PE29 6XU  
Tel: 01480 323000 www.anglianwater.co.uk

The plan is produced by Anglian Water Services Limited, from Ordnance Survey Crown Copyright, Licence 100022432. This map is to be used for the purposes of viewing the location of Anglian Water plant only. Any other use of the map data or further copies are not permitted. This notice is not intended to exclude or restrict liability for death or personal injury resulting from negligence. The original document stored in the BIM 360 Doc Project carry the version, suitability code, revision and approval information. Prints are uncontrolled and shall not be used for construction.

DRAWING No. **00001-100006-CAMEST-ZZZ-LAY-Z-9030**

REV. STAT. **A1**  
**C04 S4**



## Get in touch

You can contact us by:



Emailing at [info@cwwtpr.com](mailto:info@cwwtpr.com)



Calling our Freephone information line on **0808 196 1661**



Writing to us at **Freepost: CWWTPR**

You can view all our DCO application documents and updates on the application on The Planning Inspectorate website:

<https://infrastructure.planninginspectorate.gov.uk/projects/eastern/cambridge-waste-water-treatment-plant-relocation/>